

98 DISASSEMBLY

- Free the cable from the motorcycle.

Installation:

- Run the tachometer cable through its guide at the 3-way joint, fit the inner cable into the tachometer, and tighten the cable nut with pliers.
- Fit the bottom end of the cable into its place in the cylinder head. Turn it if necessary so that it fits all the way into place, and tighten its nut with a wrench.

HEADLIGHT UNIT

Removal:

- Take out the retaining screws (8) (2), and swing the unit 7 from the housing 20.
- Disconnect the headlight socket 6 from the rear of the unit. For semi-sealed beam units, the bulb can now be removed.
- Remove the pivot screws 2, nuts 9, washers 10, and rubber dampers (2 ea), and the beam horizontal adjusting screw 1. A nut 14, spring seat 13, and spring 12; come off with the adjusting screw.
- Separate the outer rim 3 from the inner rim 4.
- Remove the screws 11 (2), and separate the sealed beam unit from the inner rim and mounting rim 15.

Headlight Unit

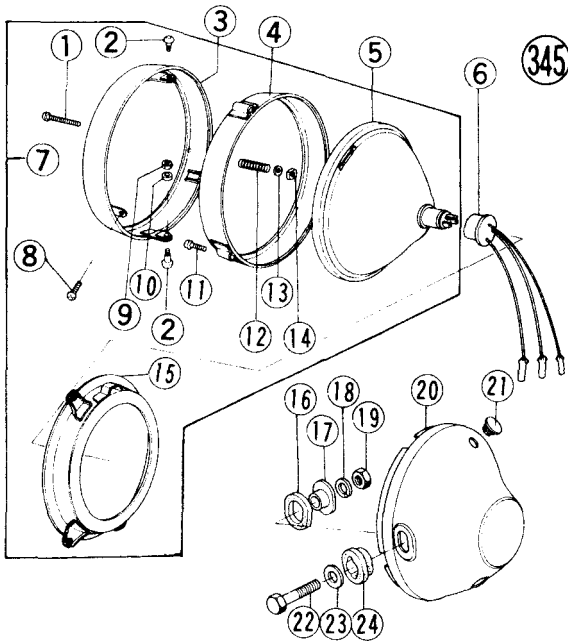

- | | |
|---------------------|-------------------|
| 1. Adjusting Screw | 13. Spring Seat |
| 2. Pivot Screw | 14. Nut |
| 3. Outer Rim | 15. Mounting Rim |
| 4. Inner Rim | 16. Damper |
| 5. Sealed Beam Unit | 17. Collar |
| 6. Socket | 18. Lock Washer |
| 7. Headlight Unit | 19. Nut |
| 8. Retaining Screw | 20. Housing |
| 9. Nut | 21. Plug |
| 10. Washer | 22. Mounting Bolt |
| 11. Screw | 23. Flat Washer |
| 12. Spring | 24. Damper |

Installation Notes:

1. Place the sealed beam unit into the mounting rim, fitting the raised portion into its holders on the mounting rim. This ensures that the part of the sealed beam unit marked "TOP" will be to the top after the headlight unit is mounted back into the headlight housing.

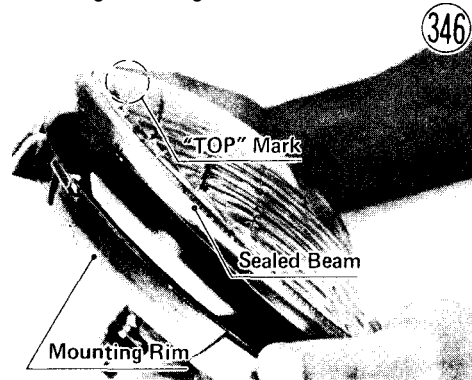

2. The washer on the adjusting screw goes between the spring and the bracket.
3. Carry out the horizontal beam adjustment after installation (Pg. 21).

SPEEDOMETER, TACHOMETER, AND ILLUMINATOR LIGHTS

Removal:

- Take out the retaining screws (2), pull the bottom of the headlight unit out of its housing, and swing the unit out from the housing.
- Disconnect the headlight socket from the rear of the unit.
- Loosen the mounting bolts underneath the headlight housing.
- Take out the headlight housing mounting bolts (2), and move the housing down slightly. A nut, lock washer, and flat washer come off with each mounting bolt.

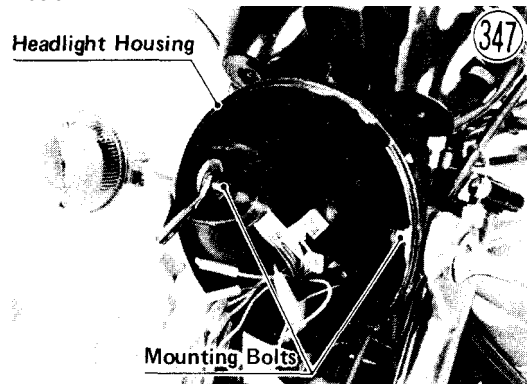

- Disconnect the upper end of the speedometer cable and tachometer cable with pliers.
- Remove the screw and lock washer, and wiring grommet from the meter cover, and pull off the cover.