

50 DISASSEMBLY

- Reconnect the motor lead onto the terminal with its nut and lock washer. Tighten the nut with 0.4 ~ 0.6 kg-m (35~52 in-lbs) of torque.
- Reinstall the rubber cap.
- Check to see that the knock pins (2) are in place and replace the dynamo cover, gasket, and screws (8). Use a new gasket and apply a liquid gasket to the wiring grommets.
- Check that the knock pins (2) are in place and replace the engine sprocket cover using the shift shaft oil seal guide (special tool) to protect the cover oil seal, and tighten its bolts (4).
- Mount the shift pedal so that its end matches the level of the engine sprocket cover lower left bolt, and tighten its bolt

NOTE: The yoke assembly (8) is not meant to be disassembled.

- Remove the planet pinions (14) and internal gear 17
- Remove the key (22), and pull off the internal gear holder 18
- Remove the large thrust washer 19

Assembly Notes:

1. Replace any O rings that are deteriorated or damaged with new ones.
2. Align the notch on the end plate with the tongue on the housing, and align the line on each end cover with its line on the housing.

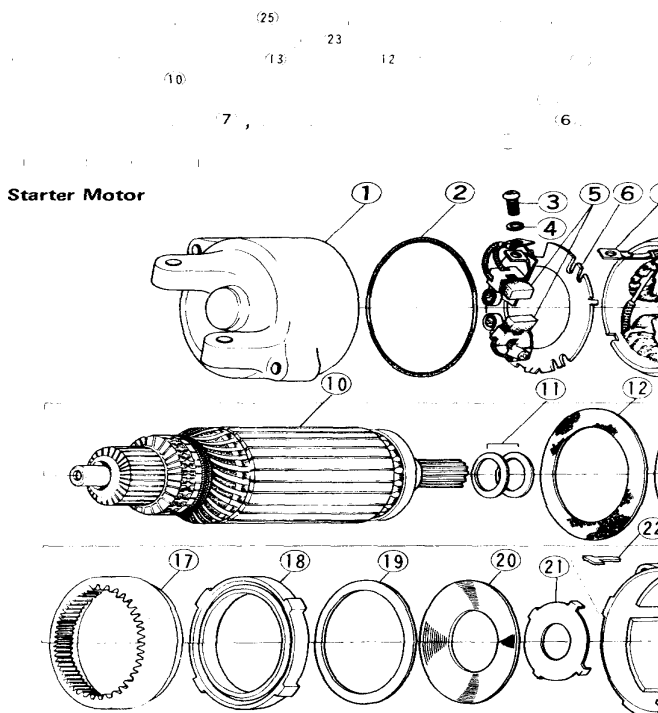

- Mount the left foot peg with its nuts and washers (2each)
- Check the oil level and add oil (Pg. 196).

Disassembly:

- Remove the screws 25 (2), lock washers (2), and remove the end covers 1, 23.
- Remove the end plate 13, gasket 12, thrust washers 11 and armature 10 from the shaft side.
- Remove the screw which connects the brush lead 5 to the field coil lead 7 and remove the brush plate 6. The screw has a lock washer. There is a O ring (2) at the brush side of the housing.

- | | | | |
|--------------------|--------------------|--------------------------|------------------|
| 1. End Cover | 9. Thrust Washers | 17. Internal Gear | 25. Screw |
| 2. O Ring | 10. Armature | 18. Internal Gear Holder | 26. O Ring |
| 3. Screw | 11. Thrust Washers | 19. Large Thrust Washer | 27. Grease Seal |
| 4. Lock Washer | 12. Gasket | 20. Spring | 28. Ball Bearing |
| 5. Carbon Brushes | 13. End Plate | 21. Toothed Washer | 29. Circlip |
| 6. Brush Plate | 14. Planet Pinions | 22. Key | |
| 7. Field Coil Lead | 15. Output Shaft | 23. End Cover | |
| 8. Yoke Assembly | 16. Thrust Washers | 24. Lock Washer | |