

42 DISASSEMBLY

•Heat the area around the guide to about 120~150°C (248~302°F), and hammer lightly on valve guide arbor (special tool) to remove the guide from the top of the head.

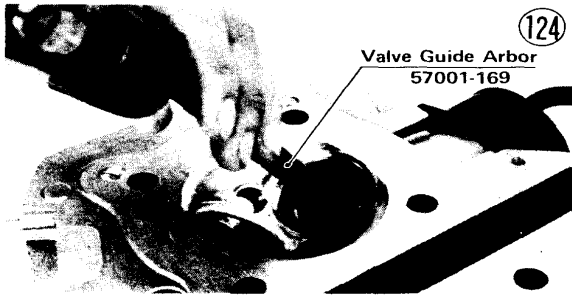

Valve and Valve Guide

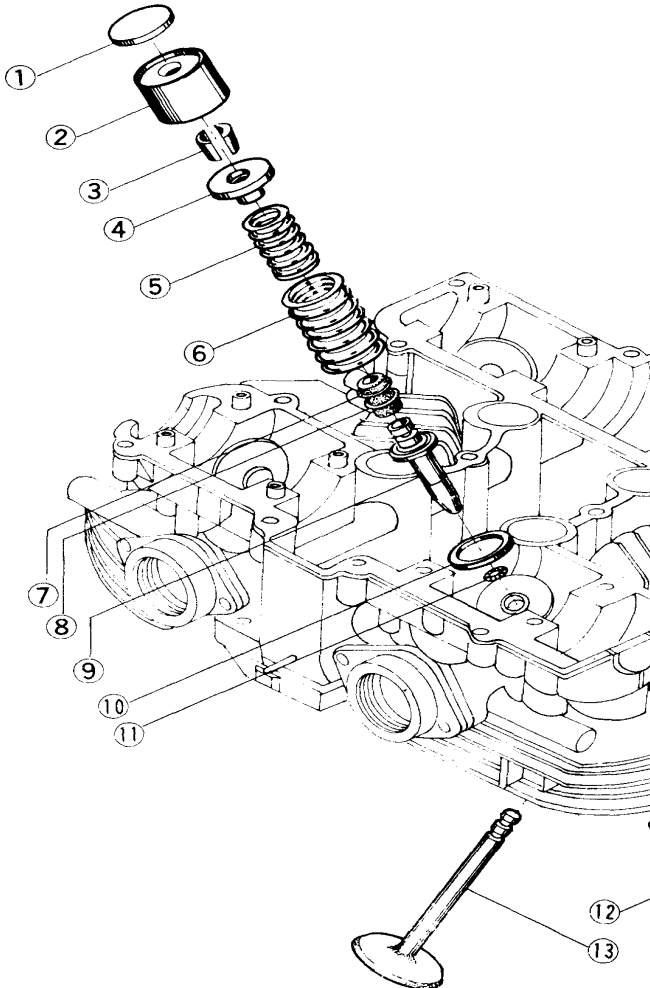

Installation (each valve and valve guide):

NOTE: If a new valve or valve guide are installed, check the valve/valve guide clearance.

- Apply oil to the valve guide, and install a new O ring 10, onto the valve guide.
- Heat the area around the valve guide hole to about 120~150°C (248~302°F), and drive the valve guide in from the top of the head using the valve guide arbor (special tool) Ream the valve guide with the valve guide reamer (special tool) even if the old guide is reused